



March 13, 2023

PRELIMINARY PUBLIC NOTICE D01-198-23

The United States Coast Guard is soliciting comments on a proposal by the Massachusetts Department of Transportation (MassDOT) to replace the General Edwards Bridge, a moveable bascule bridge, at Route 1A (North Shore Road / Lynnway) over the Saugus River with a fixed bridge.

The existing bridge is structurally deficient and functionally obsolete. The purpose of this project is to provide a safe and efficient crossing for vehicle and pedestrian traffic that serves the needs of waterway users. The objective is to construct a new bridge that would provide a structure life of at least 75 years.

MassDOT is preparing a Navigation Impact Report to evaluate the impact the proposed fixed bridge would have on vessels that pass through the bridge site. A Coast Guard Bridge Permit application has not yet been submitted but will be required for this project.

The Coast Guard is issuing this Preliminary Public Notice to solicit information on the clearances of the proposed fixed bridge. In addition to responding directly to this public notice, mariners are encouraged to complete the online MassDOT navigation survey at <https://www.mass.gov/forms/general-edwards-bridge-water-navigation-survey>

MINIMUM NAVIGATIONAL CLEARANCES:

	Vertical Clearance (MHW)	Vertical Clearance (MLW)	Horizontal Clearance
Existing Superstructure (Draw bridge)	27'-0" (closed) (Unlimited open)	36'-0" (closed) (Unlimited open)	100'- 0"
Proposed Superstructure Clearance (Fixed bridge)	34'-0" channel center 33'-8" channel edge	43'-0" channel center 42'-8" channel edge	140'- 0"

SOLICITATION OF COMMENTS:

Mariners are requested to comment on the clearances of the proposed fixed bridge, impacts to navigation, safety issues, including the need for clearance gauges and extended nighttime navigation through the bridge.

Boat owners are requested to provide information about the ability of their vessel to transit through the bridge site with the proposed clearances including type of vessel, length overall, draft, beam, and height from the waterline to the highest fixed point. Also provide contact information, where the vessel is primarily moored and the frequency of passage through the bridge site (i.e., number of times per month – a round trip should be reported as two passages).

Interested parties are requested to express their views in writing on the proposed project, giving sufficient detail to establish a clear understanding of their reasons for support of or opposition to the proposed fixed bridge. Comments will be received for the record at the address above or by e-mail to SMB-D1Boston-Bridges-PublicNotices@uscg.mil through April 14, 2023.

It is requested that this information be brought to the attention of any person having an interest who may not have received a copy of this public notice.

Concept plans of the proposed project are included in this public notice.

FOR THE DISTRICT COMMANDER:

//D. A. Fisher//

D. A. Fisher
Bridge Program Manager
By direction

This is a web-searchable copy and is not the official, signed version; however, other than the signature being omitted, it is a duplicate of the official version.



OWNER/APPLICANT:



LOCUS MAP

DRAWN BY: NMG
DATE: 01/11/2023
CHECKED BY: EMM
DATE: 01/11/2023
PROJECT NO. 608396
DWG. NO. 1 OF 3

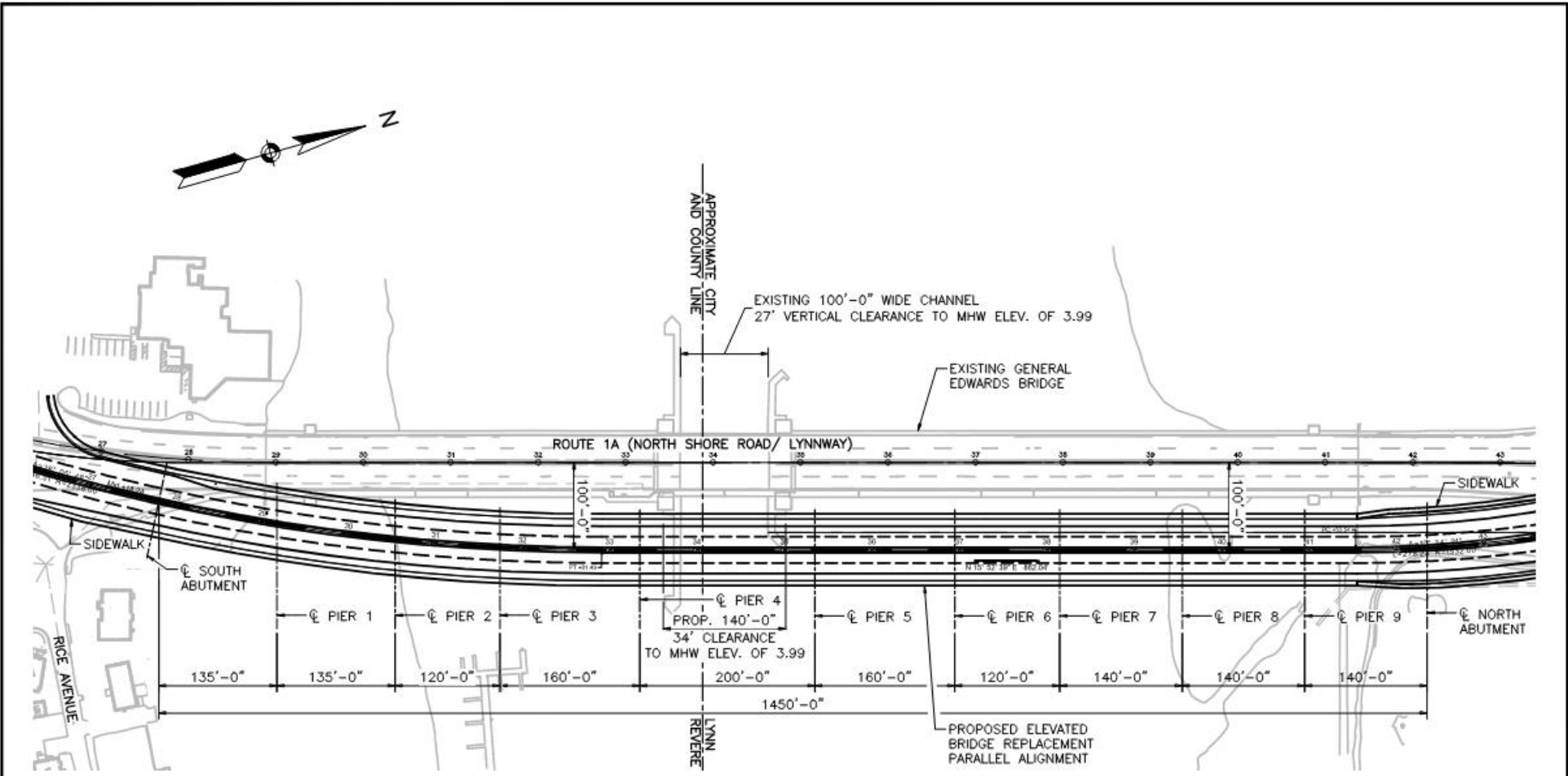

GENERAL PLAN

LEGEND:

- PROPOSED STRUCTURE
- EXISTING STRUCTURE

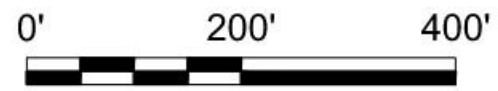

NOTE:

ELEVATIONS REFERENCE NAVD 88 DATUM.

OWNER/APPLICANT:

ROUTE 1A OVER SAUGUS RIVER (GENERAL EDWARDS BRIDGE)
 PROPOSED FIXED BRIDGE REPLACEMENT
 PLAN VIEW

DRAWN BY: NMG
DATE: 01/11/2023
CHECKED BY: EMM
DATE: 01/11/2023
PROJECT NO. 608396
DWG. NO. 2 OF 3

General Edwards Bridge, Lynn-Revere, MA									
Bridge Openings Monthly Summary									
	2015	2016	2017	2018	2019	2020	2021	2022	
Jan	0	0	0	0	0	0	1	0	
Feb	0	0	0	1	0	0	0	0	
Mar	0	0	1	1	0	0	0	0	
Apr	0	0	2	1	0	0	0	0	
May	1	1	1	1	0	0	3	0	
Jun	2	2	0	9	0	3	1	0	
Jul	1	1	0	0	0	0	0	0	
Aug	1	1	0	0	0	0	0	0	
Sep	1	0	0	0	0	0	0	0	
Oct	2	0	0	0	0	0	0	0	
Nov	0	1	0	0	0	0	0	0	
Dec	0	0	0	0	0	0	0	0	
Total Year	8	6	4	13	0	3	5	0	
Avg. Yearly Total								4.9	

General Edwards Bridge, Lynn-Revere, MA									
Bridge Openings Yearly Summary									
	2015	2016	2017	2018	2019	2020	2021	2022	Total
Fishing Vessel	0	0	0	0	0	0	0	0	0
Pleasure Boat	4	4	4	0	0	0	0	0	12
Construction	4	0	0	4	0	0	2	0	10
Test Opening	0	2	0	9	0	3	3	0	17
Total Year	8	6	4	13	0	3	5	0	39
Avg. Yearly Total (Fishing Vessel Openings)								0.0	0.0%
Avg. Yearly Total (Pleasure Boat Openings)								1.5	30.8%
Avg. Yearly Total (Construction Openings)								1.3	25.6%
Avg. Yearly Total (Test Openings)								2.1	43.6%
Total Openings (Not including test openings)							22		

