

U.S. Department of  
Homeland Security

United States  
Coast Guard



Commander  
United States Coast Guard  
Fifth Coast Guard District

431 Crawford Street  
Portsmouth, VA 23704-5004  
Staff Symbol: (dpb)  
Phone: (757) 398-6422  
Fax: (757) 398-6334  
Email: [Crystal.k.tucker@uscg.mil](mailto:Crystal.k.tucker@uscg.mil)  
or [CGDFiveBridges@uscg.mil](mailto:CGDFiveBridges@uscg.mil)

16591  
6 JAN 2023

## ***PUBLIC NOTICE D05PN-01-2023***

All interested parties are notified that an application dated December 15, 2022, has been received from the Delaware River & Bay Authority by the Commander, Fifth Coast Guard District, for approval of the location and plans for construction of new Bridge Collision Protection System for the Delaware Memorial Bridge. The bridge is across a navigable waterway of the United States.

**WATERWAY AND LOCATION:** Delaware River, mile 68.9, at New Castle, DE.

**CHARACTER OF WORK:** The proposed project consists of the installation of eight (8) solid-fill dolphin cells. Each cell measures eighty (80) feet in diameter. Four cells will be installed at the piers supporting the western towers with two cells at the upstream side and two cells on the downstream side. The same configuration would be utilized for the dolphin cells at the piers supporting the eastern towers of the bridge. The dolphin cells at the western towers will be located a minimum of 448 feet from the edge of the Delaware River Federal navigation channel while the dolphin cells at the eastern towers will be located a minimum of 443 feet from the edge of the Federal navigation channel. A temporary trestle will be placed to aid construction, but it will not impact the navigation channel. The purpose of the project is to enhance the bridge protection system.

### **MINIMUM NAVIGATIONAL CLEARANCES:**

	<b>Vertical Clearance</b>	<b>Horizontal Clearance (normal to axis of the channel)</b>
<b>Existing</b>	183 feet above mean high water	800 feet for the length of navigation channel
	175 feet above mean high water	2068 feet between the bridge piers
<b>Proposed</b>	183 feet above mean high water	800 feet for the length of navigation channel
	175 feet above mean high water	1714 feet between the bridge protective dolphins

(NAVD88) (Existing and Proposed bridges)

**ENVIRONMENTAL CONSIDERATIONS:**

The U.S Department of Transportation, Maritime Administration (USDOT, MARAD) is the lead Federal agency for compliance with the National Environmental Policy Act (NEPA). The USDOT, MARAD is acting on behalf of the U. S. Coast Guard (USCG) for all applicable environmental control laws and Executive Orders. The USDOT, MARAD approved a Categorical Exclusion (CATEX) on May 28, 2019. The USCG has tentatively determined that the environmental documentation approved by the USDOT, MARAD is adequate for USCG bridge permitting purposes and intends to prepare a memorandum to file to document a USCG CATEX. Environmental documents are available for review at the address in the letterhead above, Monday through Friday (except Federal holidays), from 8 a.m. to 4:30 p.m.

The bridge is not located in the floodplain. The 100-year flood level is + 10.0 feet from datum and the top of the dolphins are +15.0 from datum. Datum is 0.0' mean low water.

A water quality certificate was issued June 10, 2015, by the Department of Natural Resources & Environmental Control via letter dated June 9, 2015 & May 7, 2018.

The bridge construction site lies inside of a designated Coastal Zone Management area. The applicant provided the Department of Natural Resources & Environmental Control with the project location information. The Department of Natural Resources & Environmental Control issued a finding on April 21, 2015, that the project is consistent with the state's Coastal Zone Management Plan.

Comments received in response to this notice concerning environmental control laws and Executive Orders will be forwarded to USDOT, MARAD as lead Federal Agency.

**SOLICITATION OF COMMENTS:**

Mariners are requested to provide navigational information, such as the sizes and types of vessels presently owned and operated on the waterway and nature of navigation (including the extent of nighttime navigation) on the waterway. Mariners are requested to comment on the navigational clearances and need for bridge protective systems, clearance gauges, and navigational lighting on the proposed bridge modification. Please submit the attached response form.

Interested parties are requested to express their views, in writing, on the proposed bridge project, giving sufficient detail to establish a clear understanding of their reasons for support of, or opposition to, the proposed project. Comments will be received for the record at the office of Commander (dpb), Fifth Coast Guard District, 431 Crawford Street, Portsmouth, VA 23704-5004 through February 5, 2023.

HAL R. PITTS  
Bridge Program Manager  
By direction

Attachments: (1) Response Form  
(2) Location/Vicinity Maps and Plan Sheets

Delaware Memorial Bridge  
 Delaware River, mile 68.9,  
 at New Castle, DE  
**Public Notice D05PN-01-2023**  
 Response Form

It is requested that anyone having an interest in this proposed project, from the standpoint of navigation, submit vessel information, comments, and recommendations on this form to the office of Commander (dpb), Fifth Coast Guard District, 431 Crawford Street, Portsmouth, VA 23704-5004 by February 5, 2023.

<b>Vessel Information</b>	Please provide all requested information:
Vessel Type	
Use – <i>Commercial and/or Recreational</i>	
Vessel Height	
Draft	
Length	
Beam	
Tonnage	
Mooring Location	

Name (Optional): \_\_\_\_\_

Address (Optional): \_\_\_\_\_

Phone (Optional): \_\_\_\_\_

**Comments and Recommendations:** \_\_\_\_\_

---



---



---



---



---



---



---

C:\Users\khalif\OneDrive\Desktop\Drafting\DRBA\delmorbridge\122-005 DelMem\_Bridge Collision Protection\Permit - USCG122-005\_D-2544\_DRBA\_Bridge\_Protection\_Permit.dwg

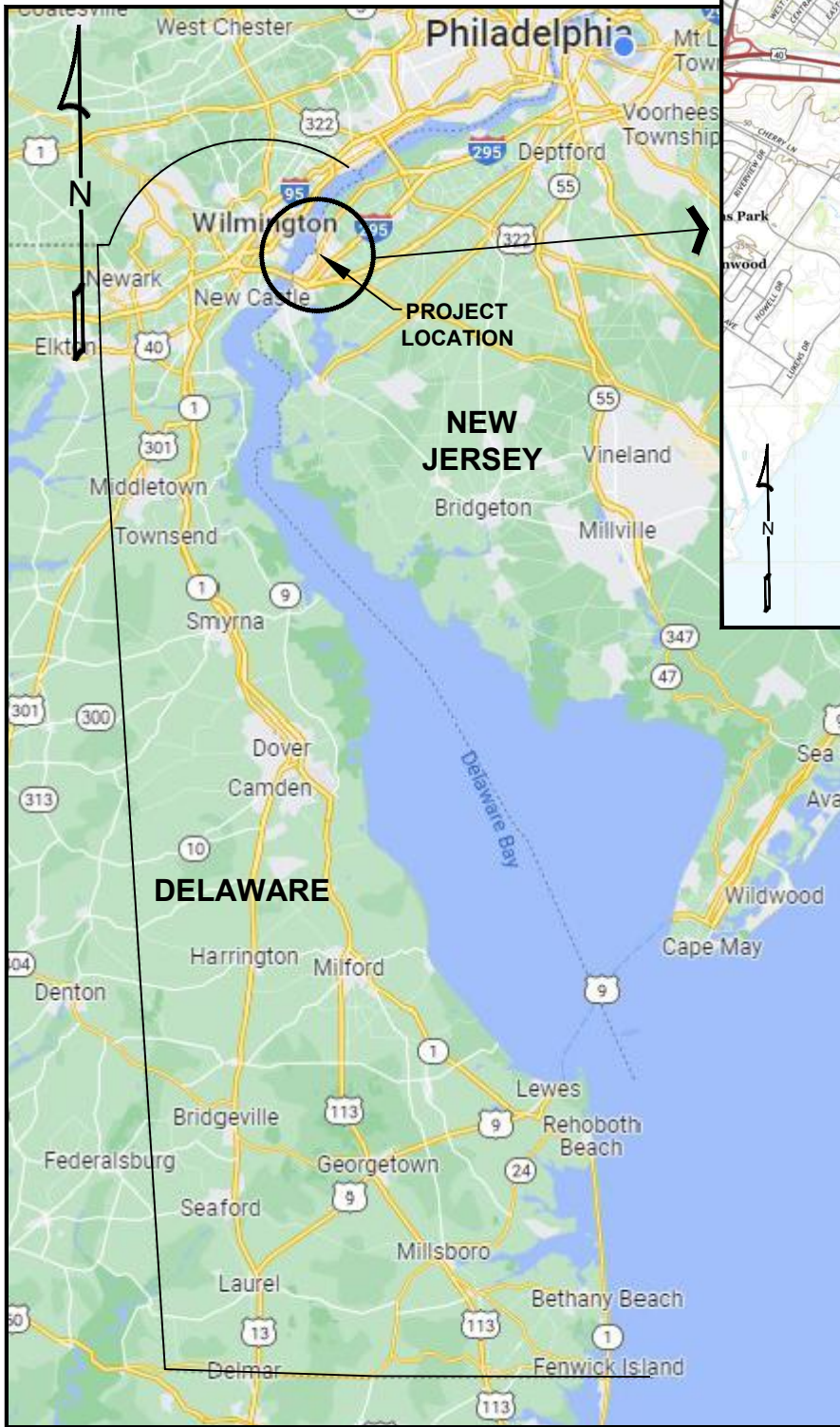

MAP DATA 2022 GOOGLE

### BRIDGE PROTECTION - LOCATION MAP

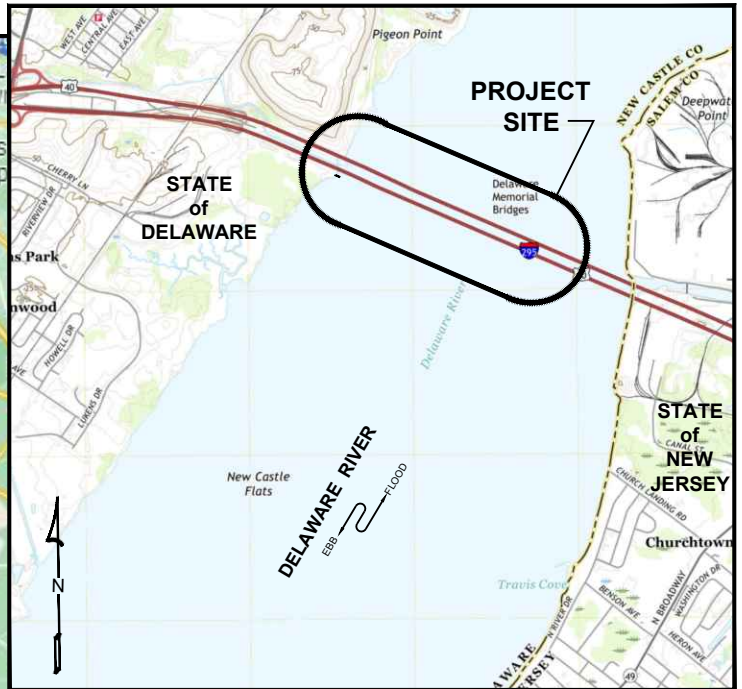

### VICINITY MAP

USGS MAP  
 WILMINGTON SOUTH QUADRANGLE  
 DELAWARE - NEW JERSEY  
 2019

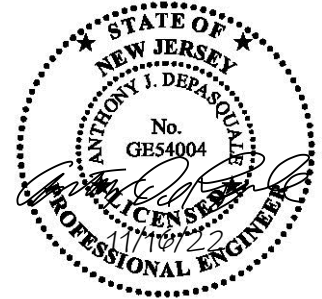
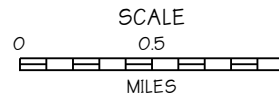

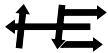
PREPARED BY:  
**S.T. HUDSON ENGINEERS, INC.**  
 PROFESSIONAL ENGINEERS & CONSULTANTS  
  
 900 Dudley Avenue  
 Cherry Hill, N.J. 08002  
 Phone 856-342-6600  
 Fax No. 856-342-8323

DELAWARE MEMORIAL BRIDGE  
 BRIDGE COLLISION PROTECTION SYSTEM  
 DELAWARE RIVER  
 MILE POINT 68.9  
 DELAWARE RIVER & BAY AUTHORITY  
 NEW CASTLE, DELAWARE  
 LOCATION MAP

DATE: 11/16/2022

SHEET: 1 of 3

C:\Users\khalif\OneDrive\Desktop\Drafting\DRBA\delmorrbridge\22-005 DelMem\_Bridge Collision Protection\Permit - USCG122-005.D\_2544\_DRBA\_Bridge\_Protection\_Permit.dwg

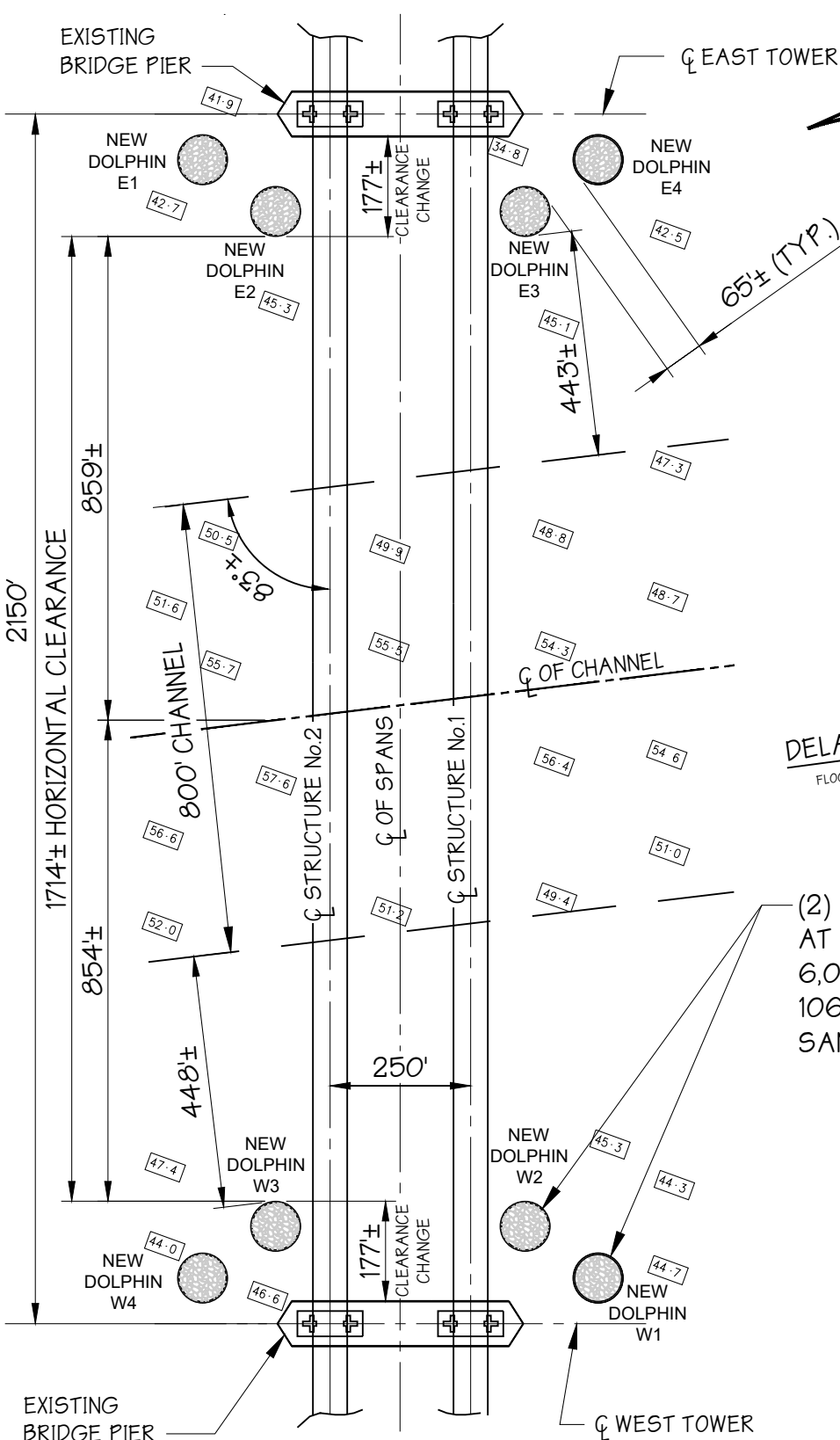

**NOTES:**

1. SOUNDINGS ARE REFERENCED TO U.S. ARMY CORPS OF ENGINEERS DATUM AND ARE EXPRESSED IN FEET AND TENTHS OF A FOOT. [48.7]
2. THE ONLY CONSTRUCTION IN THE WATERWAY IS THE DOLPHINS & TEMPORARY MARINE ACCESS TRESTLE.
3. DOLPHINS WILL BE FILLED WITH CLEAN MEDIUM SAND FROM OFF-SITE.

**DATUM CHART:**

NAVD 88 DATUM
HIGH TIDE LINE +5.5
MEAN HIGH WATER +5.3
MEAN LOW WATER +0.0

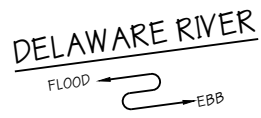

(2) NEW 79.3 Ft. DIA. DOLPHINS  
 AT (4) LOCATIONS  
 6,000 cy OF RIP-RAP  
 106,000 cy CLEAN MEDIUM  
 SAND FILL



**PLAN VIEW**

SCALE: 1" = 300'

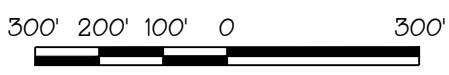

PREPARED BY:  
**S.T. HUDSON ENGINEERS, INC.**  
 PROFESSIONAL ENGINEERS & CONSULTANTS  
 900 Dudley Avenue  
 Cherry Hill, N.J. 08002  
 Phone 856-342-6600  
 Fax No. 856-342-8323

DELAWARE MEMORIAL BRIDGE  
 BRIDGE COLLISION PROTECTION SYSTEM  
 DELAWARE RIVER  
 MILE POINT 68.9  
 DELAWARE RIVER & BAY AUTHORITY  
 NEW CASTLE, DELAWARE  
 PLAN VIEW

C:\Users\lkalif\STHE Dropbox\Drafting\DRBA\delmorbridge\22-005 DelMem\_Bridge Collision Protection\Permit - USCGI22-005\_D-2544\_DRBA\_Bridge\_Protection\_Permit.dwg

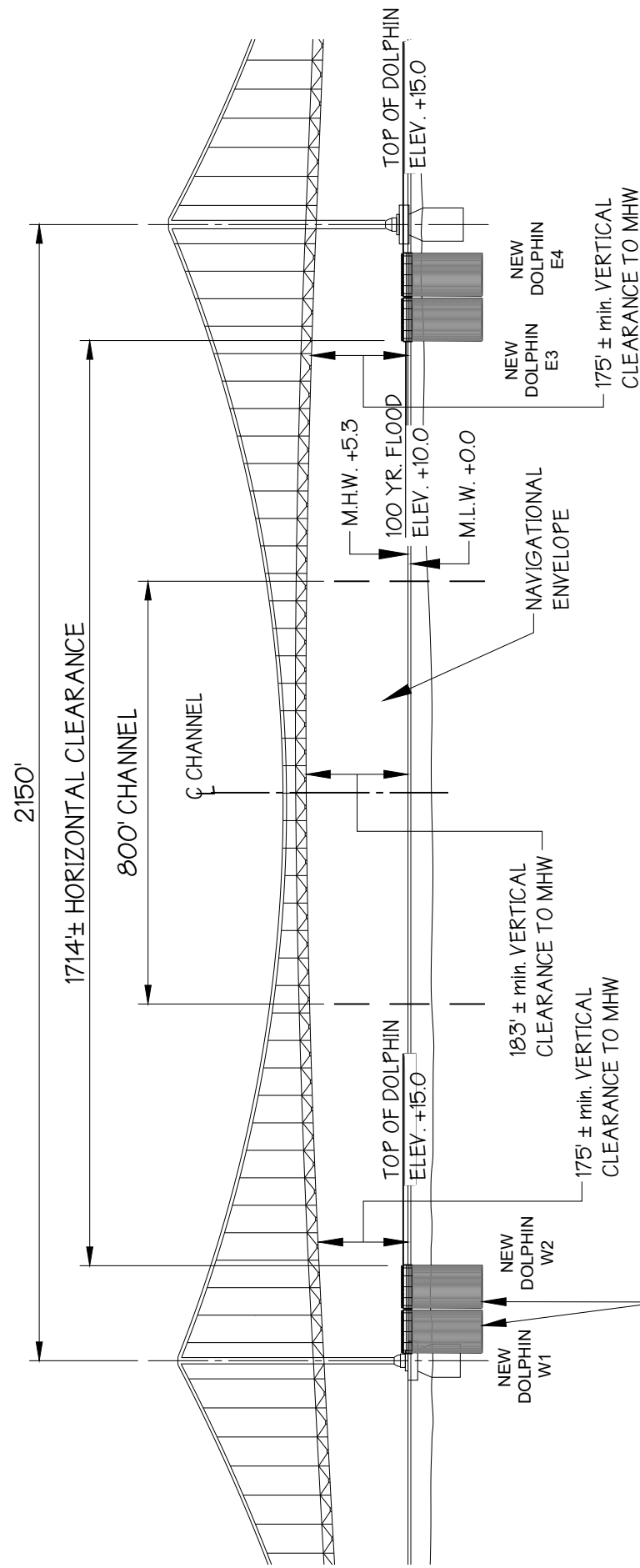

(2) NEW 79.3 Ft. DIA. DOLPHINS  
 AT (4) LOCATIONS  
 6,000 cy OF RIP-RAP  
 106,000 cy CLEAN MEDIUM  
 SAND FILL

### ELEVATION VIEW

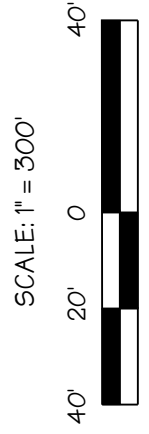

**DATUM CHART:**

NAVD 88 DATUM
HIGH TIDE LINE +5.5
MEAN HIGH WATER +5.3
MEAN LOW WATER +0.0



PREPARED BY:  
**S.T. HUDSON ENGINEERS, INC.**  
 PROFESSIONAL ENGINEERS & CONSULTANTS  
 900 Dudley Avenue  
 Cherry Hill, N.J. 08002  
 Phone 856-342-6600  
 Fax No. 856-342-8323

**DELWARE MEMORIAL BRIDGE  
 BRIDGE COLLISION PROTECTION SYSTEM  
 DELAWARE RIVER  
 MILE POINT 68.9**

DELAWARE RIVER & BAY AUTHORITY  
 NEW CASTLE, DELAWARE  
 ELEVATION VIEW

DATE: 11/16/2022 SHEET: 3 of 3





MAP DATA 2022 GOOGLE

## TEMPORARY ACCESS TRESTLE -LOCATION MAP

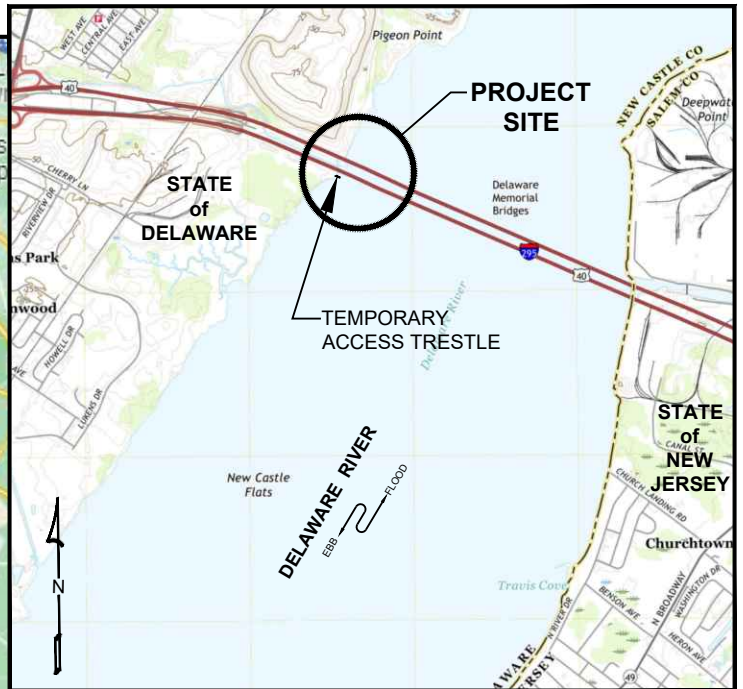
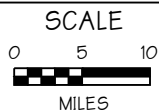

### VICINITY MAP

USGS MAP  
WILMINGTON SOUTH QUADRANGLE  
DELAWARE - NEW JERSEY  
2019

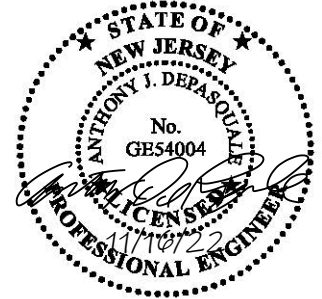
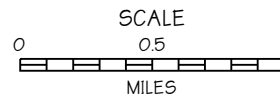

PREPARED BY:  
**S.T. HUDSON ENGINEERS, INC.**  
PROFESSIONAL ENGINEERS & CONSULTANTS  
900 Dudley Avenue  
Cherry Hill, N.J. 08002  
Phone 856-342-6600  
Fax No. 856-342-8323

DELAWARE MEMORIAL BRIDGE  
BRIDGE COLLISION PROTECTION SYSTEM  
TEMPORARY ACCESS TRESTLE  
DELAWARE RIVER - MILE POINT 68.9  
DELAWARE RIVER & BAY AUTHORITY  
NEW CASTLE, DELAWARE  
LOCATION MAP

DATE: 11/16/2022

SHEET: 1 of 4

C:\Users\khalif\STHE Dropbox\Drafting\DRBA\delmorrbridge\22-005 DelMem\_Bridge Collision Protection\Permit - USCG122-005.D-2544\_DRBA\_Bridge\_Protection\_Permit.dwg

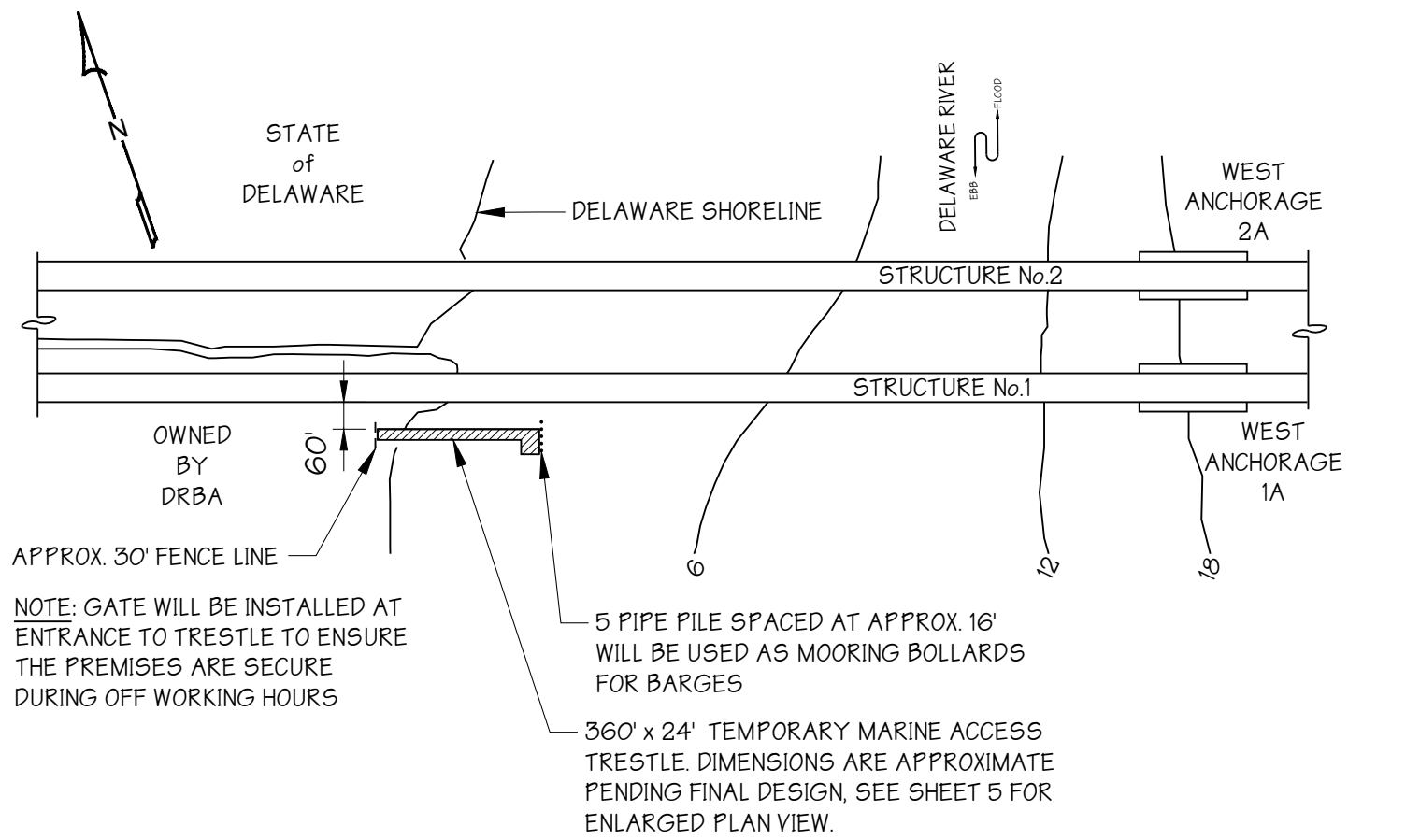

## TEMPORARY MARINE ACCESS TRESTLE - PLAN VIEW

SCALE: 1 = 400'

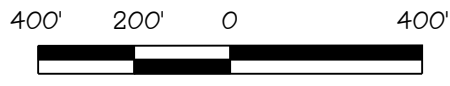

**DATUM CHART:**

NAVD 88 DATUM
HIGH TIDE LINE +5.5
MEAN HIGH WATER +5.3
MEAN LOW WATER +0.0

PREPARED BY:  
**S.T. HUDSON ENGINEERS, INC.**  
 PROFESSIONAL ENGINEERS & CONSULTANTS  

 900 Dudley Avenue  
 Cherry Hill, N.J. 08002  
 Phone 856-342-6600  
 Fax No. 856-342-8323

DELAWARE MEMORIAL BRIDGE  
 BRIDGE COLLISION PROTECTION SYSTEM  
 DELAWARE RIVER  
 MILE POINT 68.9  
 DELAWARE RIVER & BAY AUTHORITY  
 NEW CASTLE, DELAWARE  
 PLAN VIEW

DATE: 11/16/2022      SHEET: 2 of 4



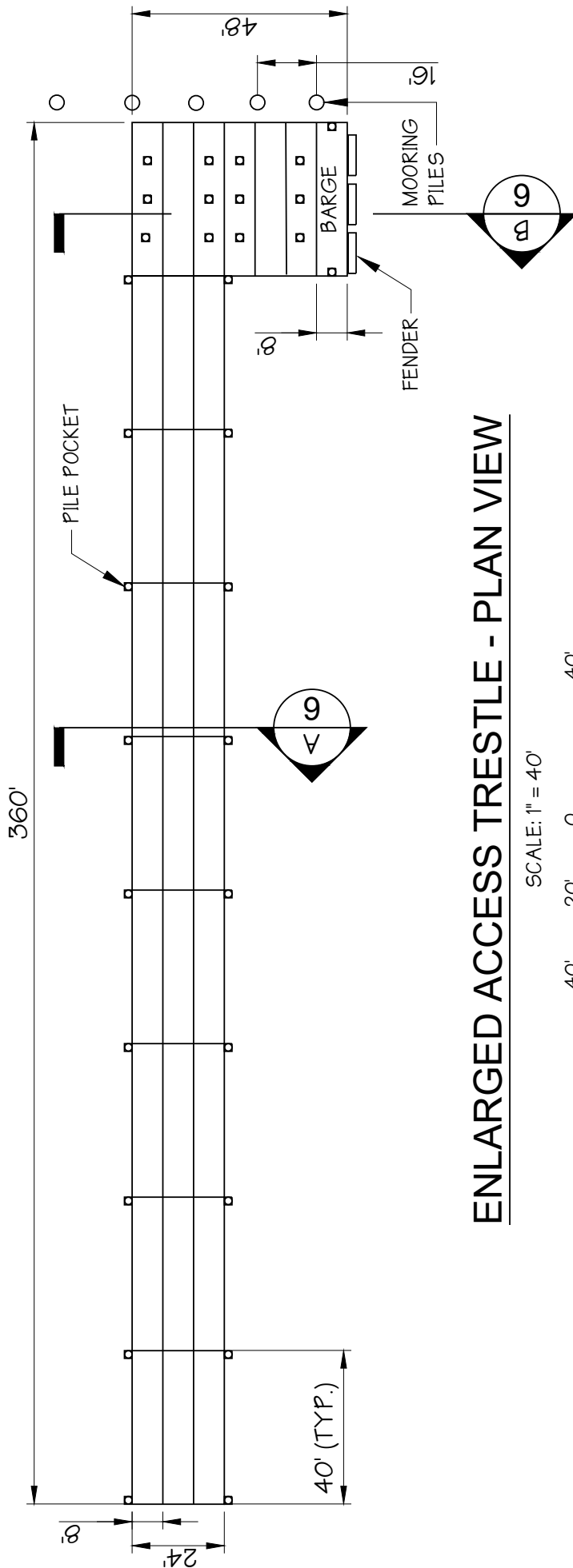

**ENLARGED ACCESS TRESTLE - PLAN VIEW**



NOTE:  
 CURRENT DIMENSIONS ARE APPROXIMATE. ESTIMATED MAXIMUM  
 WIDTH OF TRESTLE IS 24'-0". EXACT MEASUREMENTS WILL BE  
 CONFIRMED ONCE DESIGNED.

**DATUM CHART:**

NAVD 88 DATUM

HIGH TIDE LINE +5.5

MEAN HIGH WATER +5.3

MEAN LOW WATER +0.0



PREPARED BY:  
**S.T. HUDSON ENGINEERS, INC.**  
 PROFESSIONAL ENGINEERS & CONSULTANTS  
  
 900 Dudley Avenue  
 Cherry Hill, N.J. 08002  
 Phone 856-342-6600  
 Fax No. 856-342-8323

DELAWARE MEMORIAL BRIDGE  
 BRIDGE COLLISION PROTECTION SYSTEM  
 DELAWARE RIVER  
 MILE POINT 68.9  
 DELAWARE RIVER & BAY AUTHORITY  
 NEW CASTLE, DELAWARE  
 PLAN VIEW

DATE: 11/16/2022

SHEET: 3 of 4

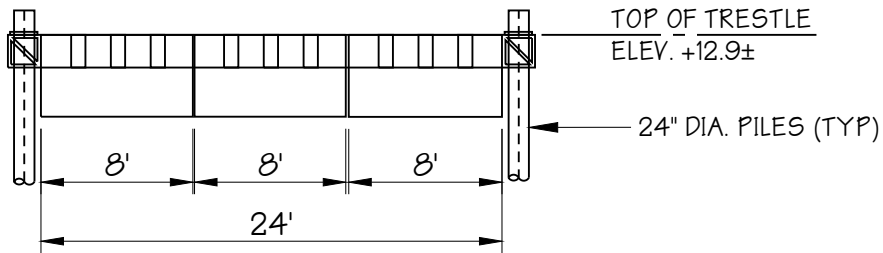

**TEMPORARY**

**MARINE ACCESS TRESTLE - SECTION**

**A**  
5

SCALE 1" = 10'

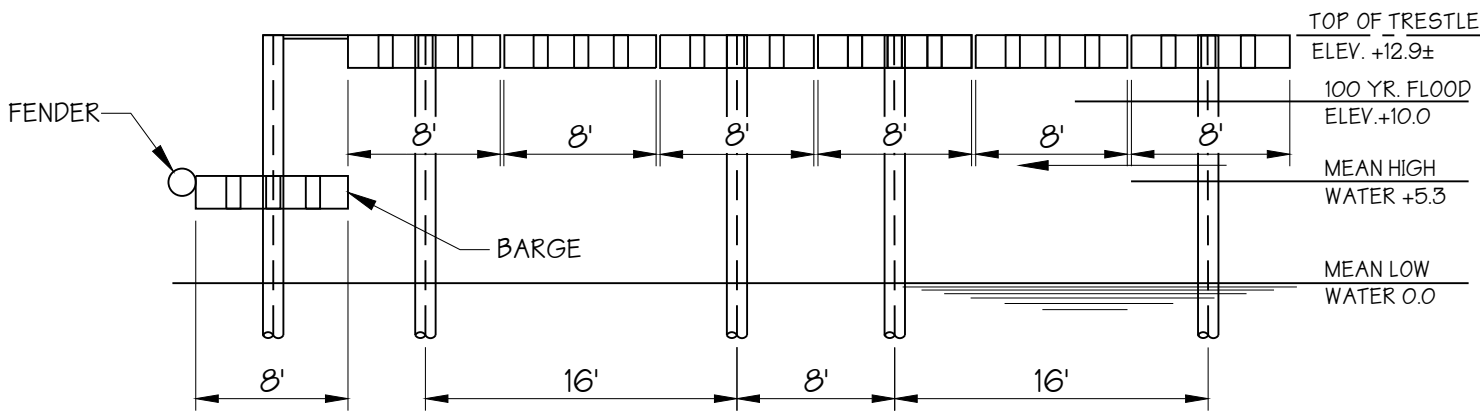

**TEMPORARY**

**MARINE ACCESS TRESTLE - SECTION**

**B**  
5

SCALE 1" = 10'

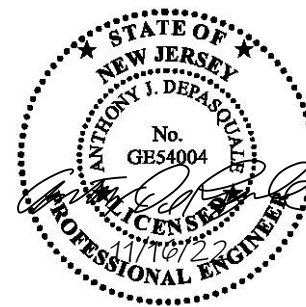

**DATUM CHART:**

- NAVD 88 DATUM
- HIGH TIDE LINE +5.5
- MEAN HIGH WATER +5.3
- MEAN LOW WATER +0.0

PREPARED BY:  
**S.T. HUDSON ENGINEERS, INC.**  
 PROFESSIONAL ENGINEERS & CONSULTANTS  
 900 Dudley Avenue  
 Cherry Hill, N.J. 08002  
 Phone 856-342-6600  
 Fax No. 856-342-8323

**DELWARE MEMORIAL BRIDGE  
 BRIDGE COLLISION PROTECTION SYSTEM  
 DELAWARE RIVER  
 MILE POINT 68.9  
 DELAWARE RIVER & BAY AUTHORITY  
 NEW CASTLE, DELAWARE  
 SECTION VIEWS**

DATE: 11/16/2022 SHEET: 4 of 4

C:\Users\khalif\OneDrive\Desktop\Drafting\DRB\DelMem\_Bridge\_Collision Protection\Permit - USCG\22-005\_DelMem\_Bridge\_Collision Protection\_Permit.dwg