



16591
December 1, 2025

PUBLIC NOTICE D01-216-2025
INTERSTATE-280 STICKEL BRIDGE
(A.K.A WILLIAM A. STICKEL MEMORIAL BRIDGE)

All interested parties are herein notified that the Commander, Northeast Coast Guard District, has received application materials dated October 28, 2025, from the New Jersey Department of Transportation for approval to convert the Interstate-280 Stickel Bridge from a vertical lift bridge to a fixed bridge over a navigable waterway of the United States.

BRIDGE, WATERWAY AND LOCATION: Interstate-280 Stickel Bridge across the Passaic River, mile 5.8, between the City of Newark and Township of Harrison, Essex and Hudson Counties, NJ.

CHARACTER OF WORK: The New Jersey Department of Transportation (NJDOT) requests to change the designation of the Interstate-280 Stickel Bridge from a drawbridge to a fixed bridge. The bridge is a vertical lift bridge that provides a 35-foot vertical clearance above Mean High Water when closed and a 135-foot vertical clearance above Mean High Water when open. The bridge has not opened for vessel transits in over 20 years. The Amtrak Dock Bridge, at mile 5.0 on the Passaic River, has a controlling vertical clearance on the waterway of 24 feet above Mean High Water. The proposed undertaking consists of officially changing the existing bridge operation regulation in 33 CFR Section 117.739 (g) to remove the Interstate-280 Stickel Bridge as an operating drawbridge, without any physical alterations to the bridge.

33 CFR 117.739 (g) states "The Interstate-280 Bridge, mile 5.8, at Harrison New Jersey, shall open on signal if at least 24 hours' notice is given by calling the number at the bridge." Should a Coast Guard bridge permit be issued for this action, the Coast Guard will ensure removal of the bridge's operating regulation once the permit is issued.

MINIMUM NAVIGATIONAL CLEARANCES:

| | Vertical | Horizontal |
|--|---|---------------------------------|
| Existing (Movable - Lift) | Open – 135 feet Closed – 35 feet | 200 feet between fenders |
| Proposed (Fixed) | 35 feet | 200 feet between fenders |

Datum: North American Vertical Datum of 1988 (NAVD88)

ENVIRONMENTAL CONSIDERATIONS:

The Coast Guard, as the lead Federal agency, has made a tentative determination that issuing a permit amendment to convert the vertical lift bridge to a fixed bridge warrants a categorical exclusion for the purposes of the National Environmental Policy Act (NEPA) as it satisfies criteria for such actions listed in the Coast Guard's NEPA Implementing Instructions.

Preliminary analysis indicates that the project would not result in adverse effects to cultural or historic resources as described in Section 106 of the National Historic Preservation Act of 1966. On October 30, 2025, the New Jersey State Historic Preservation Office concurred "that there will be no adverse to historic properties or archeological resources as a result of the conversion of the Interstate-280 Stickel Bridge from a moveable bridge to a fixed span, as proposed. Pursuant to 36 CFR §800.5(c), if no consulting parties object to this finding within the 30-day review period, the project may proceed, as proposed, unless resources are discovered during the project implementation, pursuant to 36 CFR §800.13." No comments were received.

All actions undertaken by the Coast Guard Bridge Program are subject to compliance with the National Environmental Policy Act (NEPA) and all pertinent Executive Orders and legislative acts governing environmental review for bridge permitting. This action is strictly administrative in nature, involving no construction or in-water activities related to bridge conversion. Consequently, environmental prerequisites typically associated with Coast Guard Bridge Program reviews (e.g., wetland protection, water quality certification, Clean Air Act provisions, Migratory Bird Treaty Act stipulations) are not applicable to this specific undertaking. With the exception of coordination mandated under Section 106 of the Historic Preservation Act, the Coast Guard has determined that no further environmental statutes are relevant, and no additional permits are required for this administrative action.

SOLICITATION OF COMMENTS:

Mariners and waterway users are requested to comment on the proposed navigation clearances and any other navigational safety issues, including the extent of nighttime navigation to determine the need for bridge lighting, and any concerns related to the operating schedule and regulation.

Interested parties are also requested to express their views, in writing, on the proposed bridge project including its possible environmental impacts, if any, giving sufficient detail to establish a clear understanding of the reasons for support of, or opposition to, the proposed work. Comments will be received for the record at the address noted in the header or via email SMB-D1Boston-Bridges-PublicNotices@uscg.mil through **January 2, 2026**.

Map, location and plans attached.

HITCHEN.GREGORY.P.1010980
611

G. P. Hitchen
Bridge Program Manager
By direction of the Commander
Northeast Coast Guard District

Digitally signed by
HITCHEN.GREGORY.P.1010980611
Date: 2025.12.01 13:13:07 -05'00'

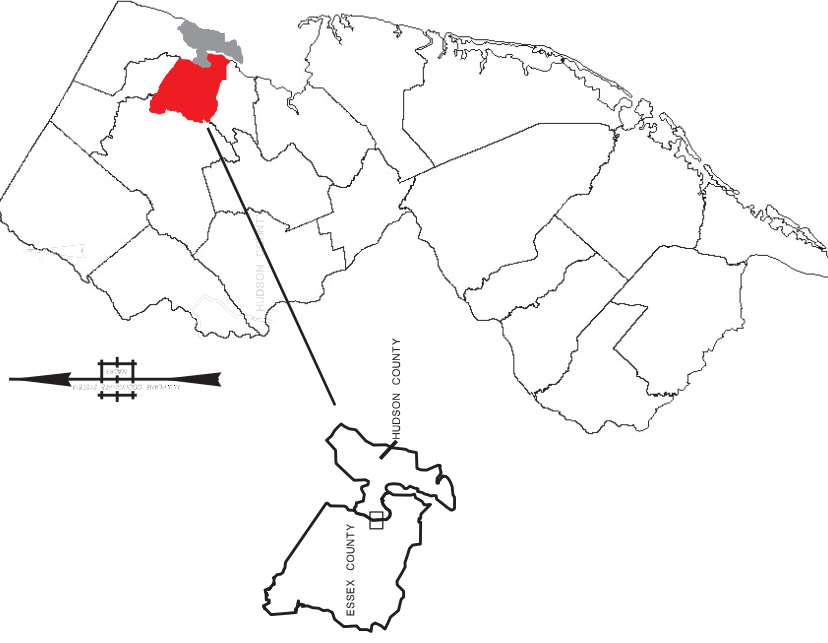
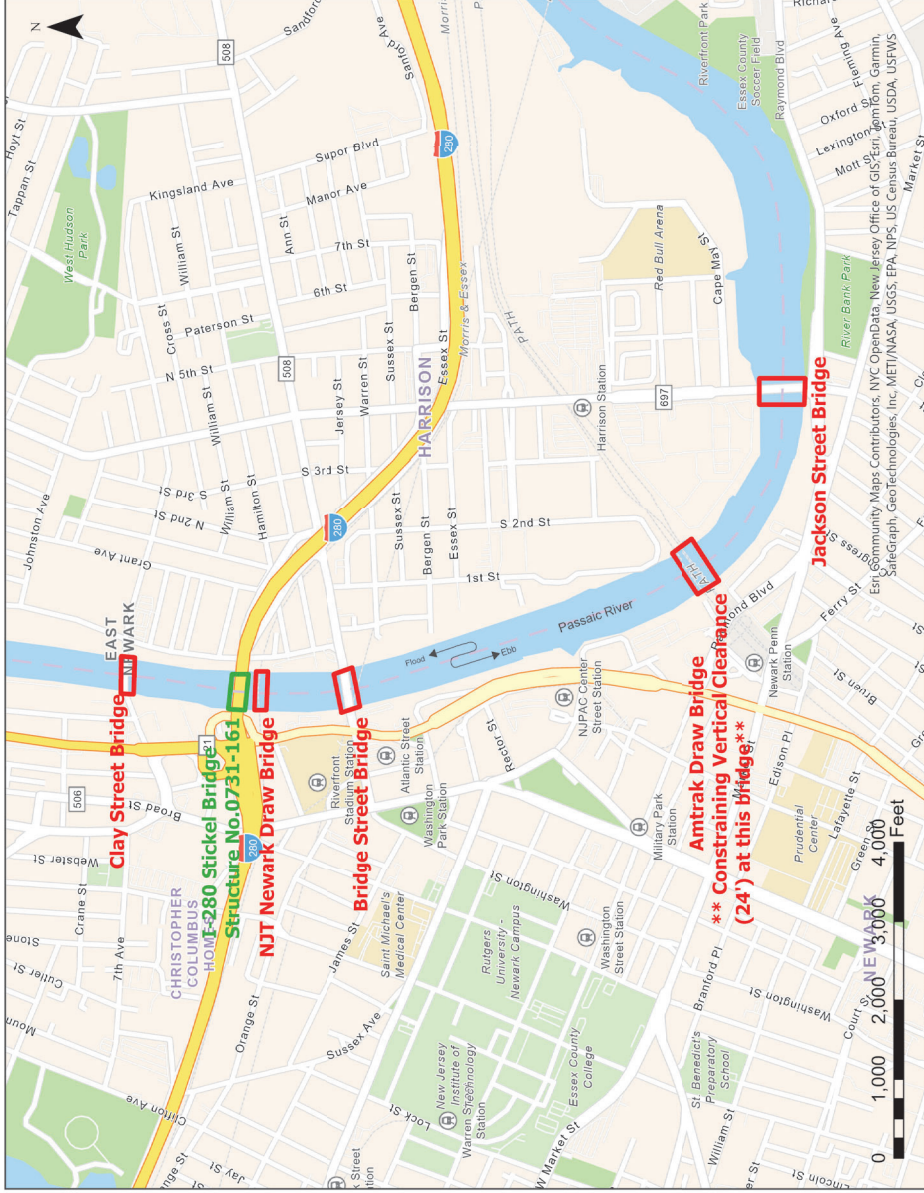

FOR PERMITTING ONLY
NOT FOR CONSTRUCTION

NEW JERSEY DEPARTMENT OF TRANSPORTATION
BUREAU OF STRUCTURAL ENGINEERING

LOCATION - VICINITY MAP

I-280 STICKEL BRIDGE
PASSAIC RIVER, RM 5.8

CITY OF NEWARK/BOROUGH
OF EAST NEWARK &
TOWNSHIP OF HARRISON

ESSEX / HUDSON NJ
COUNTY STATE

HDR, INC.

DATE: 11/26/2025

SCALE: SEE DRAWING
BRIDGE SHEET NO. 1 OF 4

PASSAIC RIVER

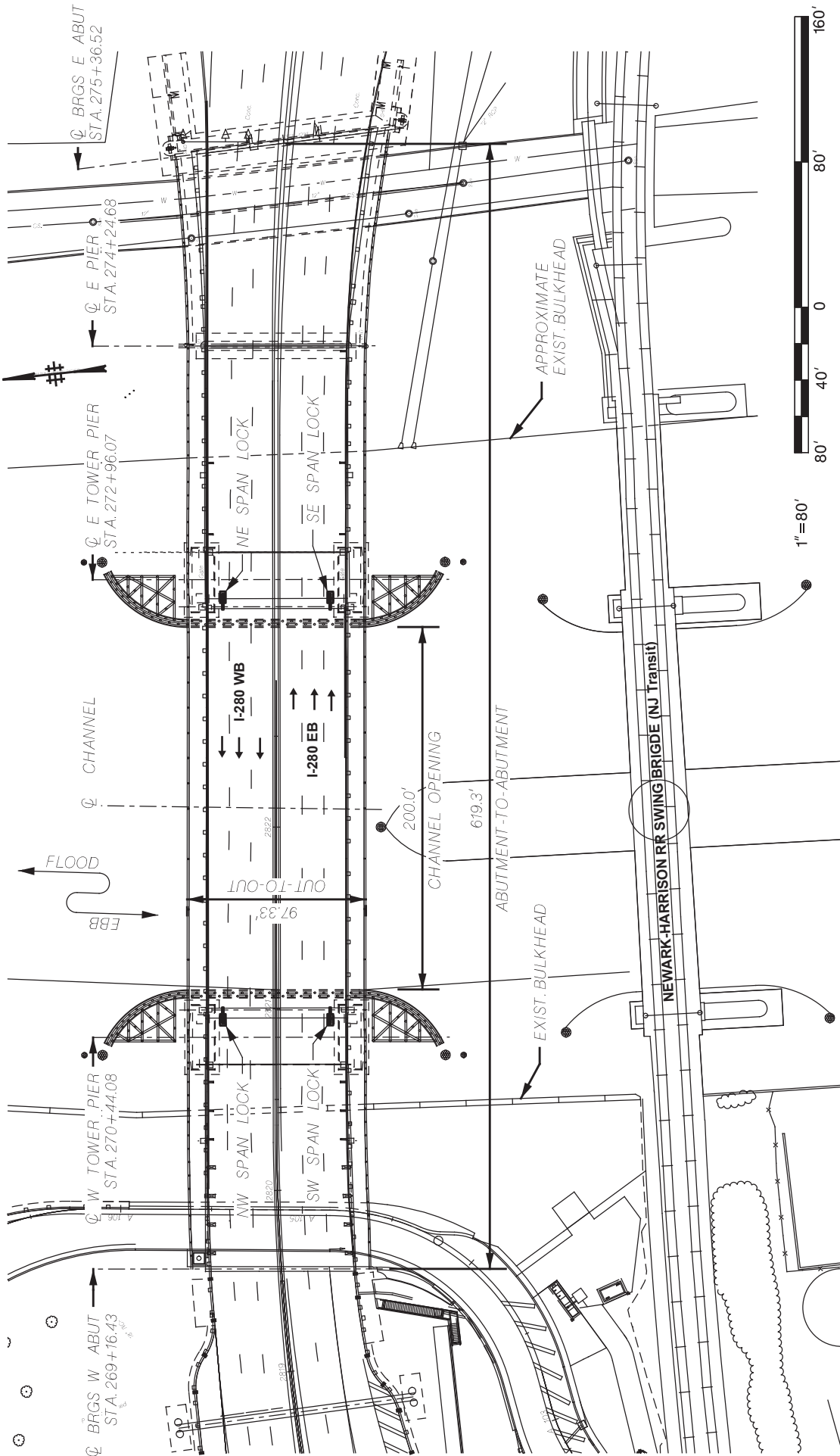

FOR PERMITTING ONLY
NOT FOR CONSTRUCTION

GENERAL PLAN
SCALE: 1" = 80'

NEW JERSEY DEPARTMENT OF TRANSPORTATION
BUREAU OF STRUCTURAL ENGINEERING

GENERAL PLAN

I-280 STICKEL BRIDGE
PASSAIC RIVER, RM 5.8

CITY OF NEWARK/BOROUGH
OF EAST NEWARK &
TOWNSHIP OF HARRISON

ESSEX / HUDSON COUNTY STATE
NJ

HDR, INC.
SCALE: SEE DRAWING
BRIDGE SHEET NO. 2 OF 4

DATE: 11/26/2025.

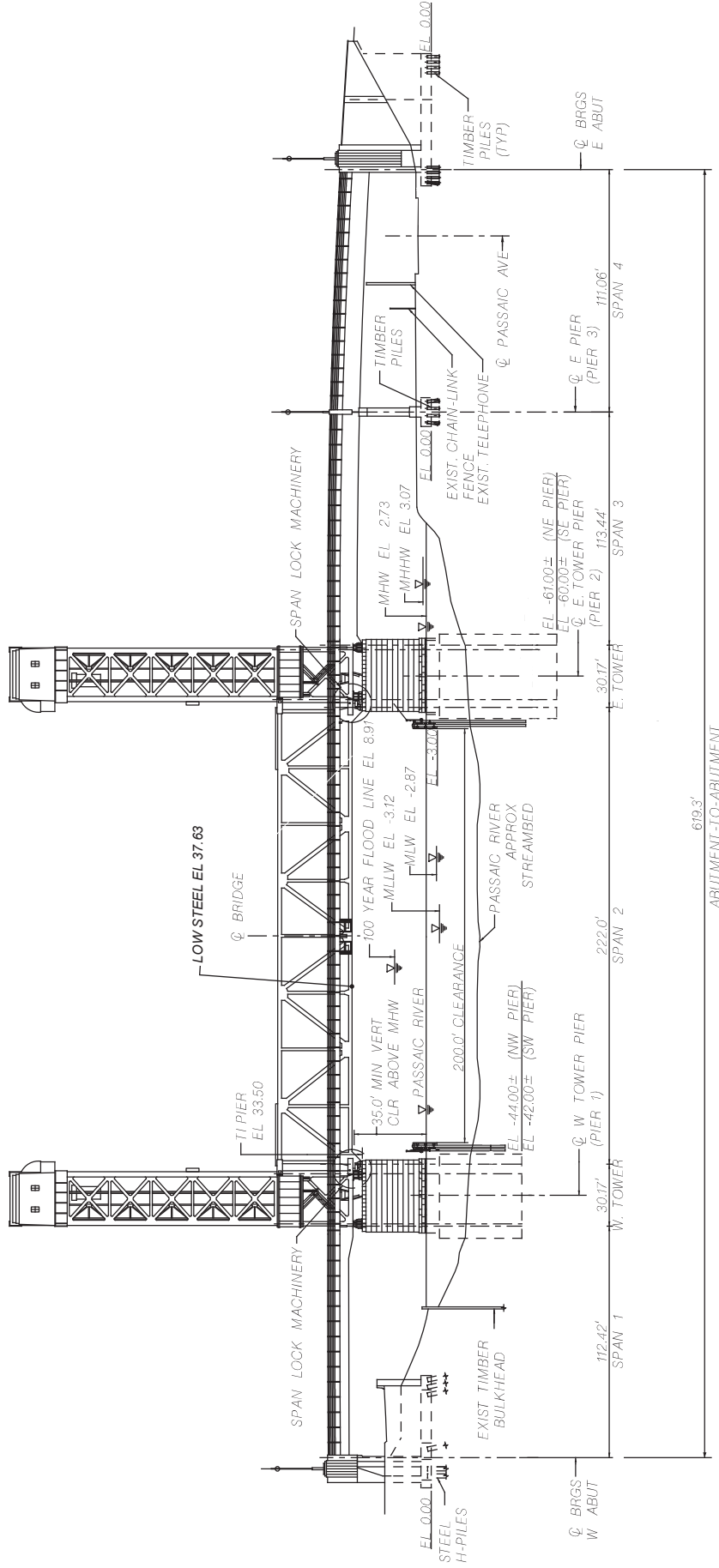

ELEVATION
(LOOKING NORTH)
SCALE: 1" = 80'

1" = 80'



*ALL VERTICLE ELEVATIONS ARE SHOWN IN
NAVD88 VERTICAL DATUM

FOR PERMITTING ONLY
NOT FOR CONSTRUCTION

NEW JERSEY DEPARTMENT OF TRANSPORTATION
BUREAU OF STRUCTURAL ENGINEERING

ELEVATION
I-280 STICKEL BRIDGE
PASSAIC RIVER, RM 5.8

CITY OF NEWARK/BOROUGH
OF EAST NEWARK &
TOWNSHIP OF HARRISON

ESSEX / HUDSON COUNTY STATE NJ

HDR, INC.

SCALE: SEE DRAWING
BRIDGE SHEET NO. 3 OF 4

DATE: 11/26/2025

3 4

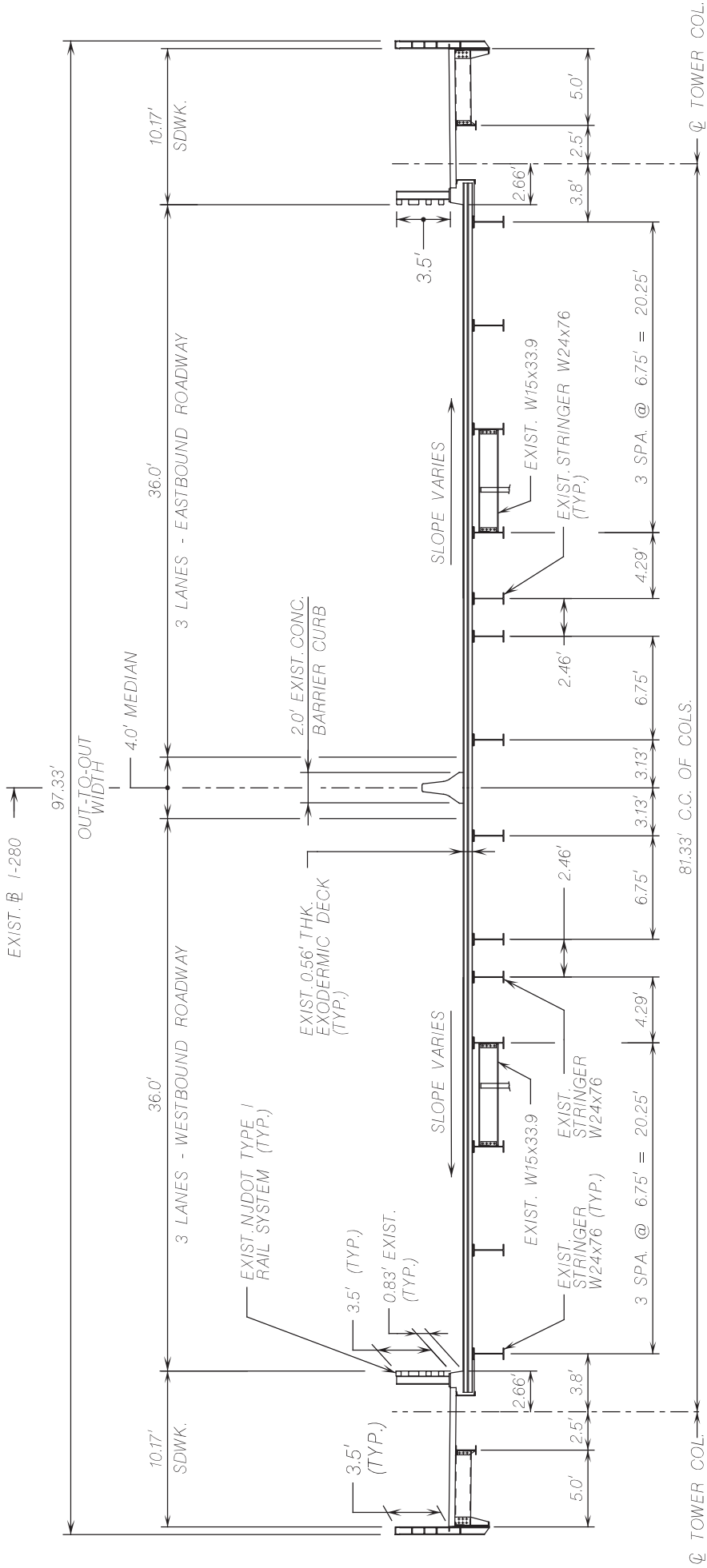

EXISTING - TYPICAL SECTION

AT TOWER SPANS
1"=10'



FOR PERMITTING ONLY
NOT FOR CONSTRUCTION

| | | | |
|---|--------|----------------|----|
| NEW JERSEY DEPARTMENT OF TRANSPORTATION BUREAU OF STRUCTURAL ENGINEERING | | | |
| LIFT SPAN CROSS SECTION I-280 STICKEL BRIDGE PASSAIC RIVER, RM 5.8 | | | |
| CITY OF NEWARK/BOROUGH OF EAST NEWARK & TOWNSHIP OF HARRISON | | ESSEX / HUDSON | NJ |
| MUNICIPALITY | COUNTY | STATE | |
| HDR, INC. | | | |
| SCALE: SEE DRAWING | | | |
| DATE: 11/26/2025 | | | |
| BRIDGE SHEET NO. 4 OF 4 | | | |